



Bath + basin wastes + bottle traps



BASIN WASTES + BOTTLE TRAPS

PAGE

POP-OUT Basin Waste

2-3

- Innovative pop-out plug+waste for basins
- Many colours available
- Universal



Ceramic POP-OUT Basin Waste

4

- Ceramic waste cap and pop-out waste
- Many colours available

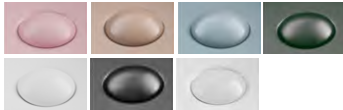

Pop-up Basin Waste

5

- Button design pop-up plug+waste
- Chrome finish



Bottle Trap

6

- For wall basins and basins with exposed plumbing
- Many colours available



BATH WASTES + KITS

PAGE

POP-OUT Bath Waste

7

- Innovative pop-out plug+waste for baths
- Many colours available
- Overflow + non-overflow



Bath Plug + Waste

8

- Chrome finish waste + white rubber plug
- Non-overflow



FlexiWaste Bath Overflow POP-OUT Kit – Premium Kit

9

- Premium pop-out waste, colour options
- Dome overflow head, colour options
- Ultra compact bath overflow/waste solution



FlexiWaste Bath Overflow Kit – Basic Kit

10

- Chrome Plug+Waste, white rubber plug
- Dome overflow head, chrome
- Ultra compact bath overflow/waste solution

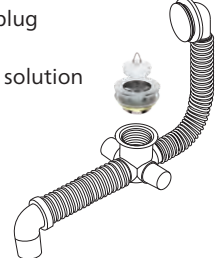

FlexiWaste Bath Kit

11

- For non-overflow baths
- Ultra compact bath waste solution
- Waste upgrade + colour options



Complete FlexiWaste options/codes

12

- Full list of FlexiWaste options
- Spare parts
- Optional extra hose

SEIMA

kitchen + laundry + bathroom ware

seima.com.au

Please note

- All measurements are in millimetres.
- Use silicone sealant. Do not use epoxy type adhesives.
- Specifications may vary without notice as part of our continuous improvement practices.
- Clean with a damp cloth. Do not use abrasive cleaners, liquids or pastes.

Pop-out Basin Waste



chrome



brushed nickel



gunmetal



brushed gold



white silk matte



black silk matte



POP OUT basin waste

- PULLS OUT!
- EASY CLEAN
- ANTI SEIZE
- ANTI CLOG



Top section pulls out for easy cleaning
Easy-clean prongs catch debris as it flows into the waste

Innovative easy-to-remove pop-out design

Why pop-OUT?

The Pop-out waste does exactly what its name suggests — the top section of the waste simply pops out (or pulls out). This patented innovation has significant advantages including:

- **REMOVABLE** The top of the waste is completely removable. Easy access, easy cleaning.
- **ANTI CLOG** The ‘prongs’ on the top section of the waste are designed to catch debris (including hair) as it flows into the waste. The streamlined simplicity of this design makes it easy to keep clear and clean.
- **ANTI SEIZE** The pop-out design eliminates the possibility of the plug seizing in the waste.
- **OPEN DESIGN** The openness of the design promotes efficient drainage.

More features ...

- **PREMIUM QUALITY** Durable, high quality finish — all components are premium quality.
- **SEIMA UNIVERSAL DESIGN** Suits 32 and 40 mm waste holes; suits overflow and non-overflow.

Order codes

192010	Pop-out Basin Waste — Chrome
192012	Pop-out Basin Waste — Brushed Nickel
192199	Pop-out Basin Waste — Gunmetal
192013	Pop-out Basin Waste — Brushed Gold
192009	Pop-out Basin Waste — White Silk Matte
192011	Pop-out Basin Waste — Black Silk Matte

Compatible with natural stone waste caps supplied with natural stone basins. Simply screw off the metal cap and replace it with the natural stone cap.

Product details

WASTE OUTLET	Universal. Suits 32 and 40 mm waste holes. Suits overflow and non-overflow.
FIXING	Must be fitted by a licensed plumber. Warranty does not cover any fault caused by installation or part installation by an unlicensed person. Please refer to the diagram for installation guidelines. It is essential that the waste is sealed correctly using silicone where shown.
MATERIALS	Solid brass base, plated/coated to achieve the colour finishes. The transparent flexible ring is premium quality.
CLEANING	Clean with soapy water. Do not use corrosive or abrasive cleaners.



Pop-out basin waste on website



SEIMA

kitchen + laundry + bathroom ware

seima.com.au

Please note

- All measurements are in millimetres.
- Use silicone sealant. Do not use epoxy type adhesives.
- Specifications may vary without notice as part of our continuous improvement practices.
- Clean with a damp cloth. Do not use abrasive cleaners, liquids or pastes.

Pop-out Basin Waste – Installation guide



Please refer to the diagrams for specific guidelines.

- It is essential that the waste is sealed correctly using silicone where shown.
- Must be fitted by a licensed plumber. The Seima warranty does not cover any fault caused by installation or part installation by an unlicensed person.
- Clean with soapy water. Do not use corrosive or abrasive cleaners.

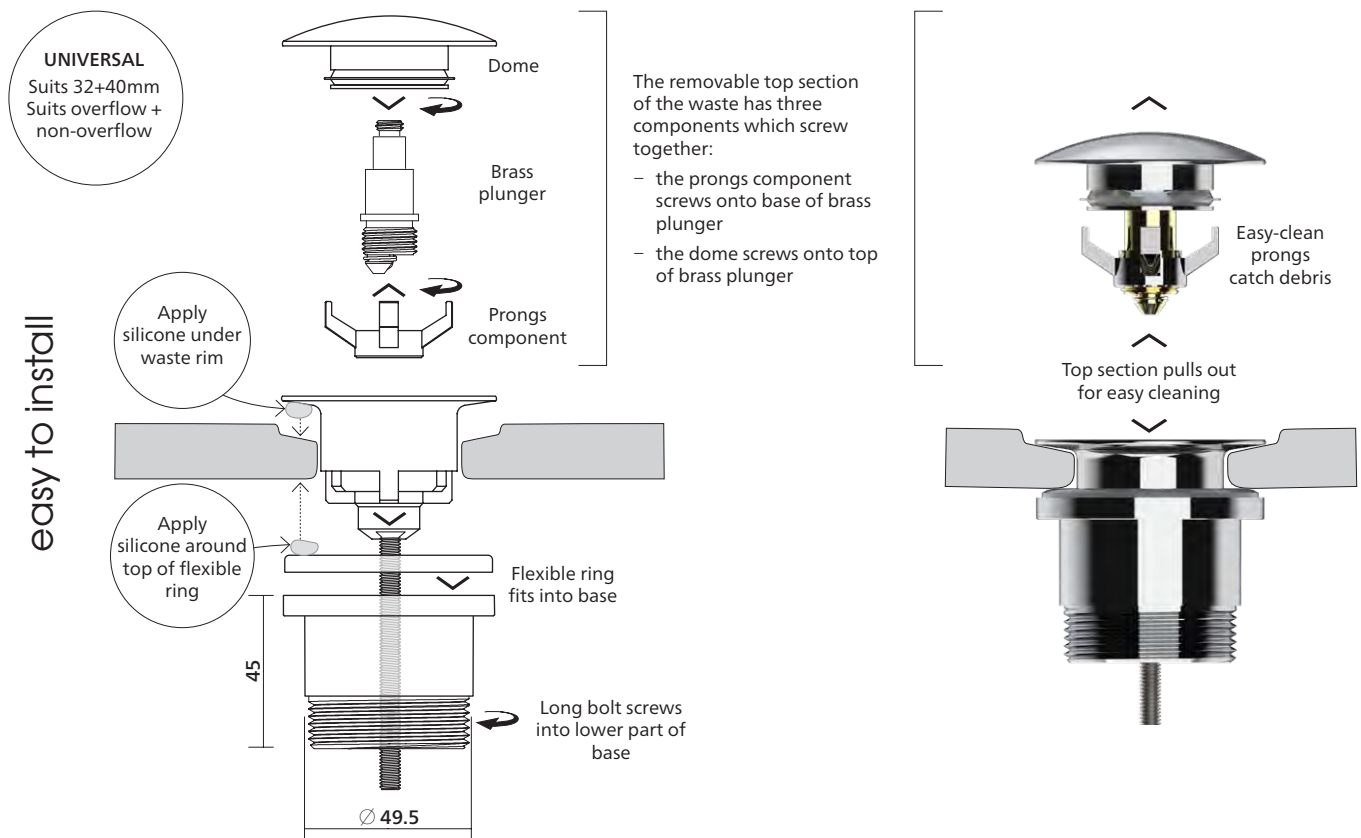

SEIMA

kitchen + laundry + bathroom ware

seima.com.au

Please note

- All measurements are in millimetres.
- Use silicone sealant. Do not use epoxy type adhesives.
- Specifications may vary without notice as part of our continuous improvement practices.
- Clean with a damp cloth. Do not use abrasive cleaners, liquids or pastes.

Ceramic Pop-out Basin Waste



POP OUT basin waste ceramic cap

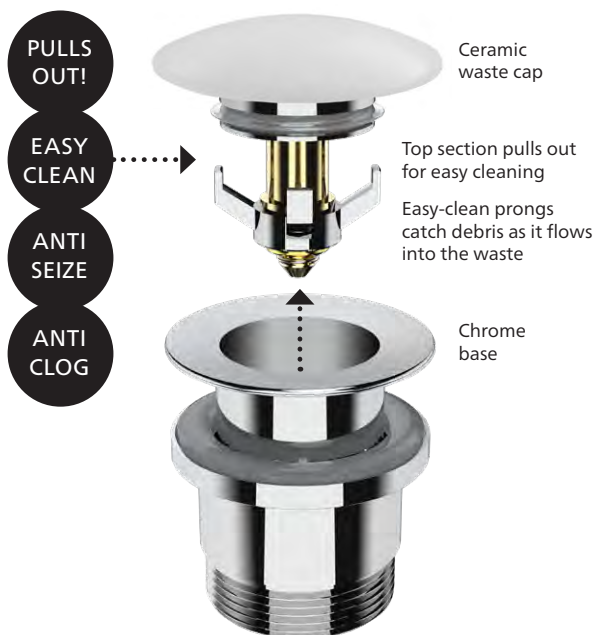

Ceramic waste cap and chrome pop-out base

Ceramic wastes offer a streamlined look for your ceramic basins. You can match the waste with your basin or choose a contrasting colour (eg black dome on white basin).

- The ceramic waste cap simply screws onto the pop-out base.
- Pop-out base has chrome finish.

Innovative easy-to-remove pop-out design

The Pop-out waste does exactly what its name suggests — the top section of the waste simply pops out (or pulls out). This patented innovation has significant advantages including:

- **REMOVABLE** The top of the waste is completely removable. Easy access, easy cleaning.
- **ANTI CLOG** The 'prongs' on the top section of the waste are designed to catch debris (including hair) as it flows into the waste. The streamlined simplicity of this design makes it easy to keep clear and clean.
- **ANTI SEIZE** The pop-out design eliminates the possibility of the plug seizing in the waste.
- **OPEN DESIGN** The openness of the design promotes efficient drainage.
- **PREMIUM QUALITY** Durable, high quality finish — all components are premium quality.
- **SEIMA UNIVERSAL DESIGN** Suits 32 and 40 mm waste holes; suits overflow and non-overflow.

Order codes – Pop-out basin waste with Ceramic cap

192257	Ceramic Pop-out Basin Waste, White Silk Matte
192258	Ceramic Pop-out Basin Waste, White Gloss
192259	Ceramic Pop-out Basin Waste, Black Silk Matte
192260	Ceramic Pop-out Basin Waste, Rose Quartz
192261	Ceramic Pop-out Basin Waste, Smoky Taupe
192262	Ceramic Pop-out Basin Waste, Winter Sea
192263	Ceramic Pop-out Basin Waste, Forest

Product details

WASTE OUTLET	Universal. Suits 32 and 40 mm waste holes. Suits overflow and non-overflow.
FIXING	Must be fitted by a licensed plumber. Warranty does not cover any fault caused by installation or part installation by an unlicensed person. Please refer to the diagram for installation guidelines. It is essential that the waste is sealed correctly using silicone where shown.
MATERIALS	Ceramic dome waste cap. Solid brass base, plated/coated to achieve the chrome finish. The transparent flexible ring is premium quality.
FINISH	All colours are available in Silk Matte finish. White is available in both Silk Matte and Gloss finishes.
COLOUR	Various colours as shown.
CLEANING	Clean with soapy water. Do not use corrosive or abrasive cleaners.

SEIMA

kitchen + laundry + bathroom ware

seima.com.au

Please note

- All measurements are in millimetres.
- Use silicone sealant. Do not use epoxy type adhesives.
- Specifications may vary without notice as part of our continuous improvement practices.
- Clean with a damp cloth. Do not use abrasive cleaners, liquids or pastes.

Pop-up Basin Waste



Button design, chrome finish, universal

Order codes

USAGE NOTE Pop-up wastes have a choice of base material, depending on the use. The PVC base is for general use. The metal base (chrome) is designed for use with a bottle trap.

Order codes

191825	Button pop-up waste, chrome, PVC base	Old code: SVA-050
191826	Button pop-up waste, chrome, chrome base	Old code: SVA-050-B

Product details

WASTE OUTLET Universal, suits 32 and 40 mm waste holes, suits overflow and non-overflow.

FIXING Must be fitted by a licensed plumber. Warranty does not cover any fault caused by installation or part installation by an unlicensed person.

Refer to the diagram below for installation guidelines.

MATERIALS Chrome plated solid brass. PVC base or metal base.

CLEANING Clean with soapy water. Do not use corrosive or abrasive cleaners.

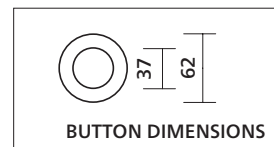
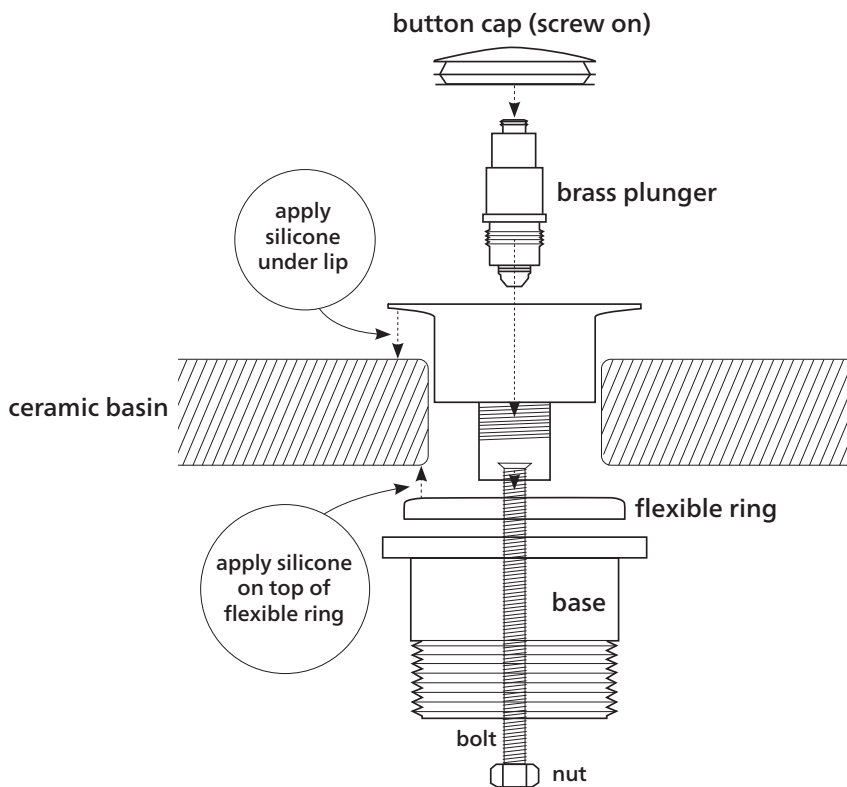

SEIMA

kitchen + laundry + bathroom ware

seima.com.au

Please note

- All measurements are in millimetres.
- Use silicone sealant. Do not use epoxy type adhesives.
- Specifications may vary without notice as part of our continuous improvement practices.
- Clean with a damp cloth. Do not use abrasive cleaners, liquids or pastes.

Bottle Trap



Bottle trap for wall basins and basins with exposed plumbing

- Wall exit available in multiple colours
- Floor exit available in Chrome only
- Solid brass base
- Suits 40 mm waste holes

Order codes

WALL EXIT	
191822	Bottle trap, wall exit, Chrome
192120	Bottle trap, wall exit, Brushed Nickel
192200	Bottle trap, wall exit, Gunmetal
192121	Bottle trap, wall exit, Brushed Gold
192122	Bottle trap, wall exit, White Matte
191836	Bottle trap, wall exit, Black Matte

FLOOR EXIT	
191835	Bottle trap, floor exit, Chrome

Product details

- WASTE** Suits 40 mm wastes.
- FIXING** Must be fitted by a licensed plumber. Warranty does not cover any fault caused by installation or part installation by an unlicensed person.
- Ensure all o-rings are lubricated with silicone based lubricant.
- Fit connection pipe to plug and washer. Adjust trap height (trim connection pipe as required) to line up with wall outlet pipe and ensure there is a minimum 1.5 degree fall in the outlet pipe when installed.
- Measure and trim outlet pipe, ensuring there is adequate allowance for pipe and rubber seal to fit into DWV female socket.
- Fit rubber seal over outlet pipe and fit into 40mm DWV female socket.
- Fit protective cover over outlet pipe prior to final connection to plumbing.
- Firmly tighten all joints. Do not over-tighten. Test for leaks.
- CLEANING** Clean with soapy water. Do not use corrosive or abrasive cleaners.
- MATERIAL** Brass alloy.

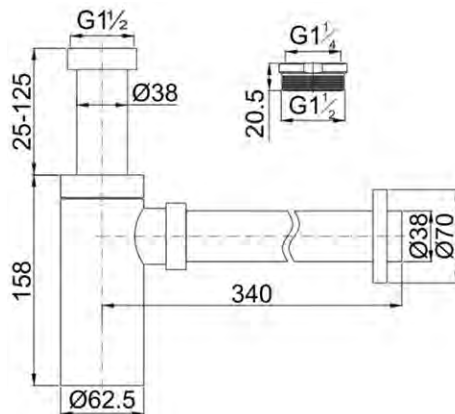

SEIMA

kitchen + laundry + bathroom ware

seima.com.au

Please note

- All measurements are in millimetres.
- Use silicone sealant. Do not use epoxy type adhesives.
- Specifications may vary without notice as part of our continuous improvement practices.
- Clean with a damp cloth. Do not use abrasive cleaners, liquids or pastes.

Pop-out Bath Waste



chrome



brushed nickel



gunmetal



brushed gold



white gloss



black silk matte



POP OUT bath waste

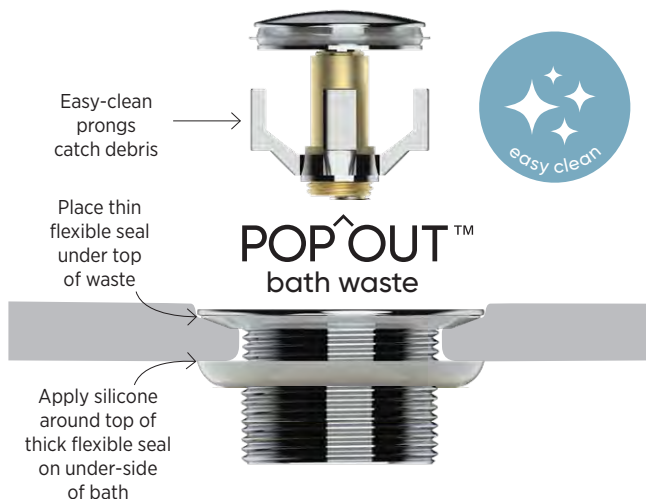
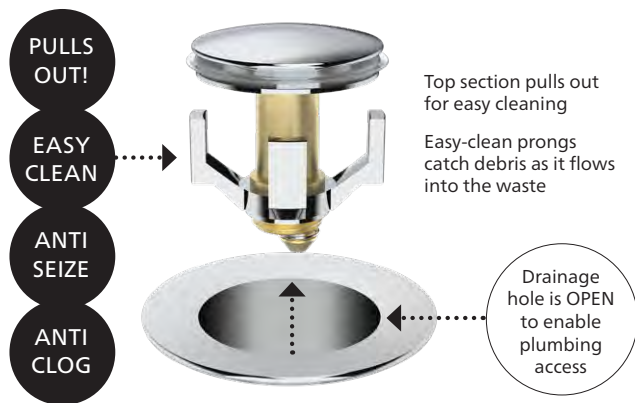

Innovative easy-to-remove pop-out design

Why pop-OUT?

The pop-out waste does exactly what its name suggests — the top section of the waste simply pops out (or pulls out). This patented innovation has significant advantages including:

- **REMOVABLE** The top of the waste is completely removable. Easy access, easy cleaning.
- **ANTI CLOG** The 'prongs' on the top section of the waste catch debris (including hair) as it flows into the waste. The streamlined simplicity of this design makes it easy to keep clear and clean.
- **ANTI SEIZE** The pop-out design eliminates the possibility of the plug seizing in the waste.
- **OPEN DESIGN** The openness of the design promotes efficient drainage.
- **PREMIUM QUALITY** Durable, high quality finish — all components are premium quality.
- **OVERFLOW OPTION** Available for overflow and non-overflow baths.
- 40 mm hole – standard size for bath wastes.
- Connects to Australian Standard pipework.
- Drains faster than a pop-up/-down waste.

Order codes

- SUITS FLEXIWASTE OVERFLOW KITS
- SUITS NON-OVERFLOW BATHS

192014	Seima Pop-out Bath Waste — Chrome
192016	Seima Pop-out Bath Waste — Brushed Nickel
192201	Seima Pop-out Bath Waste — Gunmetal
192017	Seima Pop-out Bath Waste — Brushed Gold
192197	Seima Pop-out Bath Waste — White Gloss
192015	Seima Pop-out Bath Waste — Black Silk Matte

• SUITS BATHS WITH INTEGRATED OVERFLOW

192023	Seima Pop-out Bath Waste, overflow — Chrome
192025	Seima Pop-out Bath Waste, overflow — Brushed Nickel
192202	Seima Pop-out Bath Waste, overflow — Gunmetal
192026	Seima Pop-out Bath Waste, overflow — Brushed Gold
192198	Seima Pop-out Bath Waste, overflow — White Gloss
192024	Seima Pop-out Bath Waste, overflow — Black Silk Matte

Product details

WASTE OUTLET Suits 40 mm waste holes.

FIXING Must be fitted by a licensed plumber. Warranty does not cover any fault caused by installation or part installation by an unlicensed person. Please refer to the diagram for installation guidelines. It is essential that the waste is sealed correctly using silicone where shown.

MATERIALS Solid brass base, plated/coated to achieve the colour finishes. The transparent flexible ring is premium quality.

CLEANING Clean with soapy water. Do not use corrosive or abrasive cleaners.



WaterMark
WMTS 040
LN 23422

SEIMA

kitchen + laundry + bathroom ware

seima.com.au

Please note

- All measurements are in millimetres.
- Use silicone sealant. Do not use epoxy type adhesives.
- Specifications may vary without notice as part of our continuous improvement practices.
- Clean with a damp cloth. Do not use abrasive cleaners, liquids or pastes.

Bath Plug + Waste



Chrome waste + white rubber plug

- Durable, high quality finish.
- Chrome plated solid brass body and white rubber plug.
- Suits non-overflow baths and FlexiWaste kits.
- 40 mm hole – standard size for bath wastes.
- Connects to Australian Standard pipework.

Order code

192007 Bath waste and rubber plug (no overflow)

Product details

WASTE OUTLET Suits 40 mm waste holes.

FIXING Must be fitted by a licensed plumber. Warranty does not cover any fault caused by installation or part installation by an unlicensed person.

Please refer to the diagram for installation guidelines. It is essential that the waste is sealed correctly using silicone where shown.

MATERIALS Solid brass base with chrome finish. Rubber plug.

CLEANING Clean with soapy water. Do not use corrosive or abrasive cleaners.

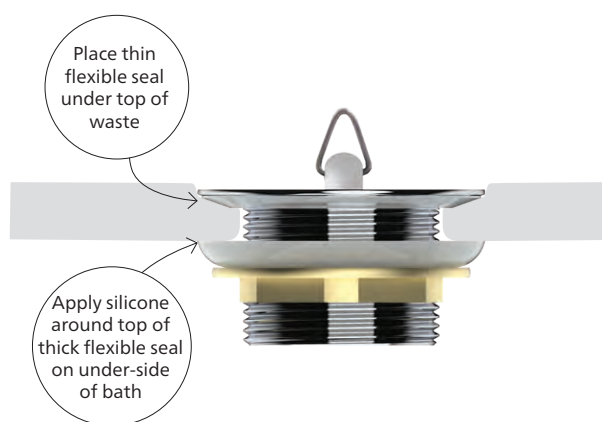

WaterMark
WMTS 040
LN 23422

SEIMA

kitchen + laundry + bathroom ware

seima.com.au

Please note

- All measurements are in millimetres.
- Use silicone sealant. Do not use epoxy type adhesives.
- Specifications may vary without notice as part of our continuous improvement practices.
- Clean with a damp cloth. Do not use abrasive cleaners, liquids or pastes.

FlexiWaste Bath Overflow Pop-out Kit – Premium kit

FlexiWaste™

bath overflow POP^OUT kit

with Pop-out Bath Waste + colour options

Universal
ULTRA COMPACT
bath waste
solution

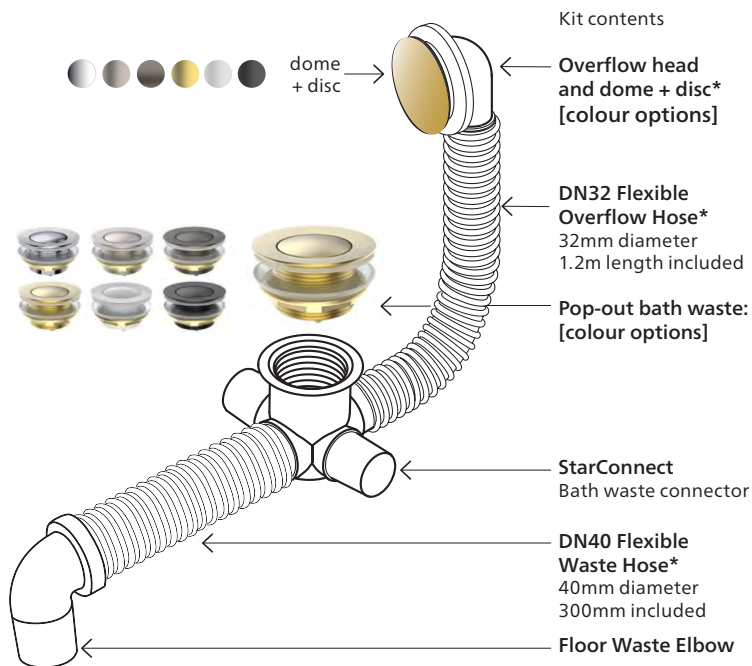

* Longer hose lengths available separately.
The overflow head comes with a chrome finish dome as standard.
Colour dome and disc replace standard fittings.

FlexiWaste Premium bath overflow kit

Kit includes

- Premium Pop-out Bath Waste – colour options
- Overflow dome – colour options
- Overflow kit

FlexiWaste offers a universal ultra-compact bath waste solution. The innovative StarConnect bath waste connector has an ultra-low 75mm profile under the bath, and multi-directional input and outlet options.

Order codes

PREMIUM KIT

FlexiWaste Bath Overflow Pop-out Kit – Premium

Includes Pop-out Bath Waste + colour options

192235	FlexiWaste Bath OF Pop-out Kit, Brushed Nickel
192236	FlexiWaste Bath OF Pop-out Kit, Black Silk Matte
192237	FlexiWaste Bath OF Pop-out Kit, White Gloss
192238	FlexiWaste Bath OF Pop-out Kit, Gunmetal
192239	FlexiWaste Bath OF Pop-out Kit, Brushed Gold
192240	FlexiWaste Bath OF Pop-out Kit, Chrome

Flexible hose lengths – Optional extra

192175	DN40 Flexible waste hose, 300mm long
192209	DN40 Flexible waste hose, 500mm long
192210	DN40 Flexible waste hose, 1.0m long
192176	DN32 Flexible overflow hose, 1.2m long
192208	DN32 Flexible overflow hose, 2.0m long

Product details

MATERIALS StarConnect connector, floor waste elbow – PVC.
Waste – Metal.
Flexible hose – Corrugated PVC.
Overflow head – Metal (chrome finish), PVC, rubber seal.

INSTALLATION Please refer to installation instructions.

CLEANING Clean with soapy water. Do not use corrosive or abrasive cleaners.

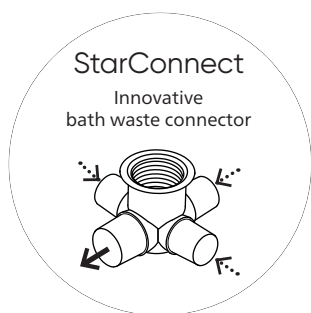

The StarConnect advantage

- 1** Ultra-low 75mm profile under bath
- 2** Multi-directional input + outlet options
- 3** Knock-out openings on all three DN32 spigots



Designed and made in Australia by SEIMA.
This SEIMA innovation is a patented, registered design.

SEIMA

kitchen + laundry + bathroom ware

seima.com.au

Please note

- All measurements are in millimetres.
- Use silicone sealant. Do not use epoxy type adhesives.
- Specifications may vary without notice as part of our continuous improvement practices.
- Clean with a damp cloth. Do not use abrasive cleaners, liquids or pastes.

FlexiWaste Bath Overflow Kit – Basic kit

FlexiWaste™

bath overflow kit – basic

with Plug+Waste, chrome/white rubber

Universal
ULTRA COMPACT
bath waste
solution

FlexiWaste Basic bath overflow kit

Kit includes

- Plug+Waste, chrome, white rubber plug
- Overflow dome, chrome
- Overflow kit

FlexiWaste offers a universal ultra-compact bath waste solution. The innovative StarConnect bath waste connector has an ultra-low 75mm profile under the bath, and multi-directional input and outlet options.

Order codes

BASIC KIT

FlexiWaste Bath Overflow Kit – Basic

Includes Chrome Plug+Waste, white rubber plug

192180 FlexiWaste Bath OF Kit – Basic, with Plug+Waste, chrome/white rubber

Flexible hose lengths – Optional extra

192175 DN40 Flexible waste hose, 300mm long
192209 DN40 Flexible waste hose, 500mm long
192210 DN40 Flexible waste hose, 1.0m long

192176 DN32 Flexible overflow hose, 1.2m long
192208 DN32 Flexible overflow hose, 2.0m long

Product details

MATERIALS StarConnect connector, floor waste elbow – PVC. Waste – Metal. Flexible hose – Corrugated PVC. Overflow head – Metal (chrome finish), PVC, rubber seal.

INSTALLATION Please refer to installation instructions.

CLEANING Clean with soapy water. Do not use corrosive or abrasive cleaners.

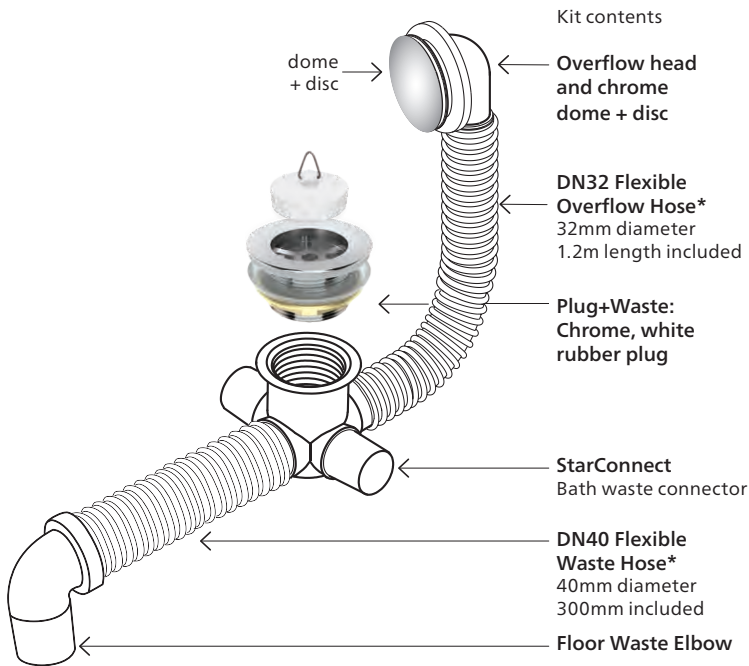

* Longer hose lengths available separately.

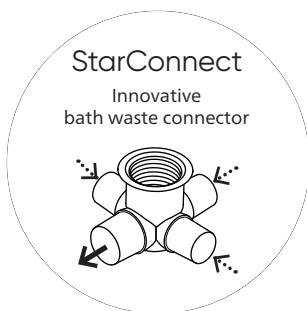

The StarConnect advantage

- 1 Ultra-low 75mm profile under bath
- 2 Multi-directional input + outlet options
- 3 Knock-out openings on all three DN32 spigots



Designed and made in Australia by SEIMA. This SEIMA innovation is a patented, registered design.

SEIMA

kitchen + laundry + bathroom ware

seima.com.au

Please note

- All measurements are in millimetres.
- Use silicone sealant. Do not use epoxy type adhesives.
- Specifications may vary without notice as part of our continuous improvement practices.
- Clean with a damp cloth. Do not use abrasive cleaners, liquids or pastes.

FlexiWaste Bath Kit

FlexiWaste™

bath waste kit

suits non-overflow baths

Plug+Waste
Chrome
White rubber plug



StarConnect
Bath waste
connector

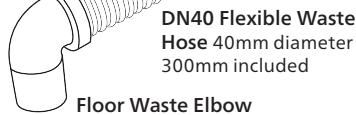
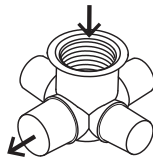
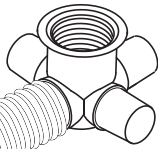

**DN40 Flexible Waste
Hose** 40mm diameter
300mm included

Floor Waste Elbow

The StarConnect advantage

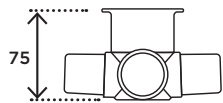

Ultra low 75mm
profile under bath

NOTE Only the DN40 Spigot is used in this FlexiWaste Bath Kit. (The three DN32 spigots are only needed for FlexiWaste Overflow Kits. These can be left intact.)

Ultra-compact bath waste solution (non-overflow)

- Chrome plug+waste with white rubber plug
- Waste upgrade options available – see Pop-out Bath Waste

Order codes

FLEXIWASTE BATH KIT

192178 Seima FlexiWaste Kit (complete kit)

EXTRA FLEXIBLE HOSE – OPTIONAL EXTRA – SPARE PARTS

192175 DN40 Flexible waste hose, 300mm long

192209 DN40 Flexible waste hose, 500mm long

192210 DN40 Flexible waste hose, 1.0m long

KIT COMPONENTS AVAILABLE SEPARATELY – SPARE PARTS

191992 StarConnect bath waste connector, PVC

191993 Floor waste elbow, PVC

192007 Plug+Waste, chrome, white rubber plug (non-overflow)

192175 DN40 Flexible waste hose, 300mm long

Product details

MATERIALS StarConnect connector, floor waste elbow – PVC.
Plug+Waste – Metal waste (chrome finish), white rubber plug.
Flexible hose – Corrugated PVC.

INSTALLATION Please refer to installation instructions.

CLEANING Clean with soapy water. Do not use corrosive or abrasive cleaners.



Designed and made in Australia by SEIMA.
This SEIMA innovation is a patented, registered design.

SEIMA

kitchen + laundry + bathroom ware

seima.com.au

Please note

- All measurements are in millimetres.
- Use silicone sealant. Do not use epoxy type adhesives.
- Specifications may vary without notice as part of our continuous improvement practices.
- Clean with a damp cloth. Do not use abrasive cleaners, liquids or pastes.

FlexiWaste – Complete list of kits, options + codes

Bath Overflow + Waste Kits

PREMIUM KIT

FlexiWaste Bath Overflow Pop-out Kit

Includes Pop-out Bath Waste + colour options

192235	FlexiWaste Bath OF Pop-out Kit, Brushed Nickel
192236	FlexiWaste Bath OF Pop-out Kit, Black Silk Matte
192237	FlexiWaste Bath OF Pop-out Kit, White Gloss
192238	FlexiWaste Bath OF Pop-out Kit, Gunmetal
192239	FlexiWaste Bath OF Pop-out Kit, Brushed Gold
192240	FlexiWaste Bath OF Pop-out Kit, Chrome

BASIC KIT

FlexiWaste Bath Overflow Kit – Basic

Includes Chrome Plug+Waste, white rubber plug

192180	FlexiWaste Bath OF Kit – Basic, with Plug+Waste, chrome/white rubber
--------	--

Bath Waste Kit *(no overflow)*

FlexiWaste Bath Waste Kit – Basic

Includes Chrome Plug+Waste, white rubber plug

192178	FlexiWaste Bath Kit, with Plug+Waste, chrome/white rubber
--------	---

Optional extra hose

Flexible hose lengths available separately

192175	DN40 Flexible waste hose, 300mm long
192209	DN40 Flexible waste hose, 500mm long
192210	DN40 Flexible waste hose, 1.0m long
192176	DN32 Flexible overflow hose, 1.2m long
192208	DN32 Flexible overflow hose, 2.0m long

FlexiWaste kit components

191992	StarConnect bath waste connector, PVC
191993	Floor waste elbow, PVC
192177	Overflow head (all parts including chrome dome)
192176	DN32 Flexible overflow hose, 1.2m long
192175	DN40 Flexible waste hose, 300mm long

Colour overflow dome + disc for FlexiWaste

(Colour dome+disc replace standard chrome fittings)

192195	Pop-out Bath Waste, overflow – Brushed Nickel
192203	Pop-out Bath Waste, overflow – Gunmetal
192196	Pop-out Bath Waste, overflow – Brushed Gold
192193	Pop-out Bath Waste, overflow – White Gloss
192194	Pop-out Bath Waste, overflow – Black Silk Matte

Pop-out Bath Wastes

- SUITS FLEXIWASTE OVERFLOW KITS
- SUITS NON-OVERFLOW BATHS

192014	Pop-out Bath Waste – Chrome
192016	Pop-out Bath Waste – Brushed Nickel
192201	Pop-out Bath Waste – Gunmetal
192017	Pop-out Bath Waste – Brushed Gold
192197	Pop-out Bath Waste – White Gloss
192015	Pop-out Bath Waste – Black Silk Matte

- SUITS BATHS WITH INTEGRATED OVERFLOW ONLY

192023	Pop-out Bath Waste, overflow – Chrome
192025	Pop-out Bath Waste, overflow – Brushed Nickel
192202	Pop-out Bath Waste, overflow – Gunmetal
192026	Pop-out Bath Waste, overflow – Brushed Gold
192198	Pop-out Bath Waste, overflow – White Gloss
192024	Pop-out Bath Waste, overflow – Black Silk Matte

Plug+Waste

192007	Bath Plug+Waste, Chrome/white rubber plug
--------	---

FlexiWaste

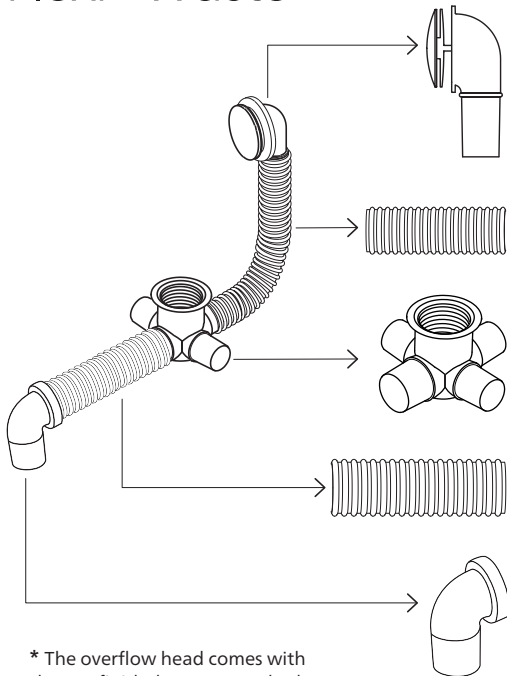

* The overflow head comes with chrome finish dome as standard.

Kit components

Overflow head and dome + disc*
[chrome as standard]

DN32 Flexible Overflow Hose
32mm diameter
1.2m length in kit

StarConnect
Bath waste connector

DN40 Flexible Waste Hose
40mm diameter
300mm in kit

Floor Waste Elbow

Optional extra hose

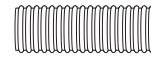

DN32 Flexible Overflow Hose
32mm diameter
Optional extra lengths:
• 1.2 metres long
• 2.0 metres long

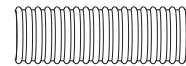

DN40 Flexible Waste Hose
40mm diameter
300mm in kit
Optional extra lengths:
• 300 mm long
• 500 mm long
• 1 metre long

Colour overflow dome + disc

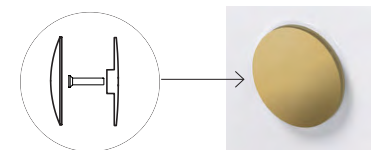

SEIMA

kitchen + laundry + bathroom ware

seima.com.au

Please note

- All measurements are in millimetres.
- Use silicone sealant. Do not use epoxy type adhesives.
- Specifications may vary without notice as part of our continuous improvement practices.
- Clean with a damp cloth. Do not use abrasive cleaners, liquids or pastes.